

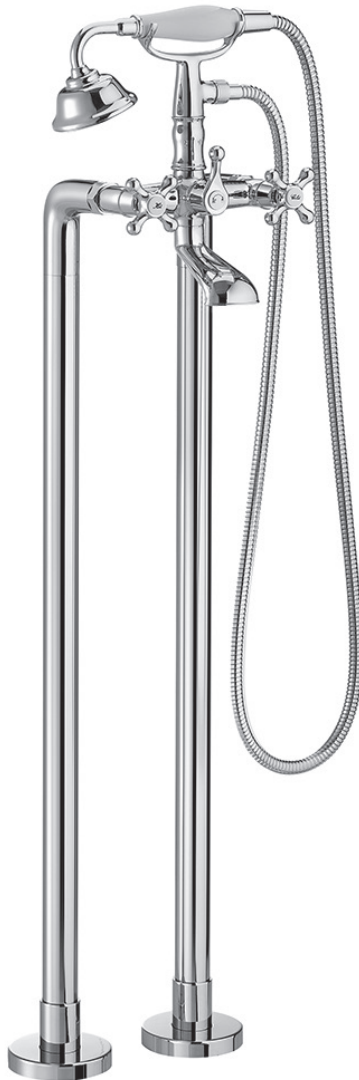

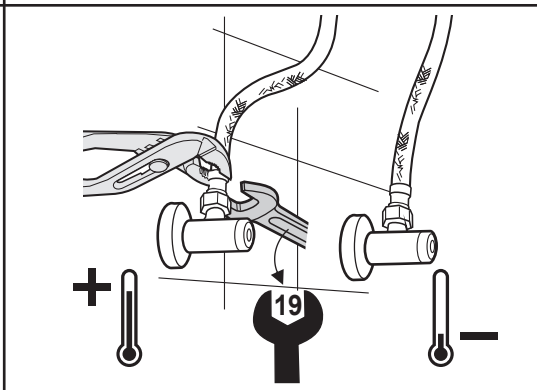

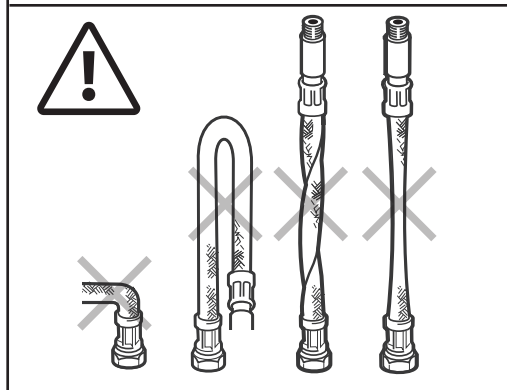

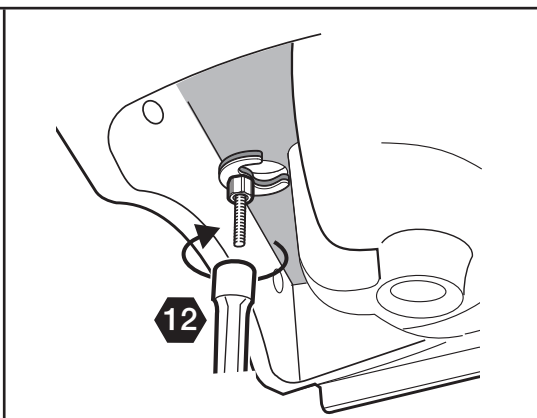

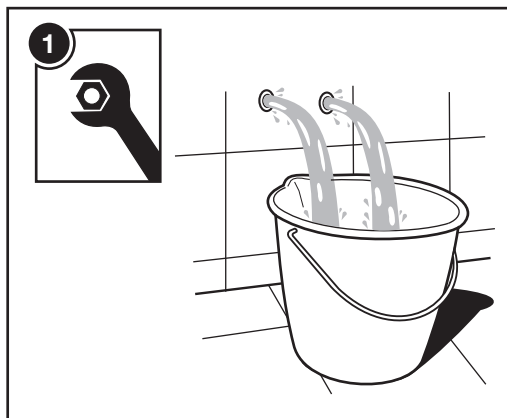











Roca

CARMEN



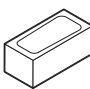

 P 	P bar	 MAX. 10	
 P 	P bar	MIN. 0,5  MAX. 10	3  
 T 	T °C	 -80 MAX. -45 MIN.	 -65 -50 
 Q (3 bar)	l/min	 9	 20  14

1 - 000000000	5 - 000000000	9 - 000000000
2 - 000000000	6 - 000000000	10 - 000000000
3 - 000000000	7 - 000000000	11 - 000000000
4 - 000000000	8 - 000000000	12 - 000000000

2

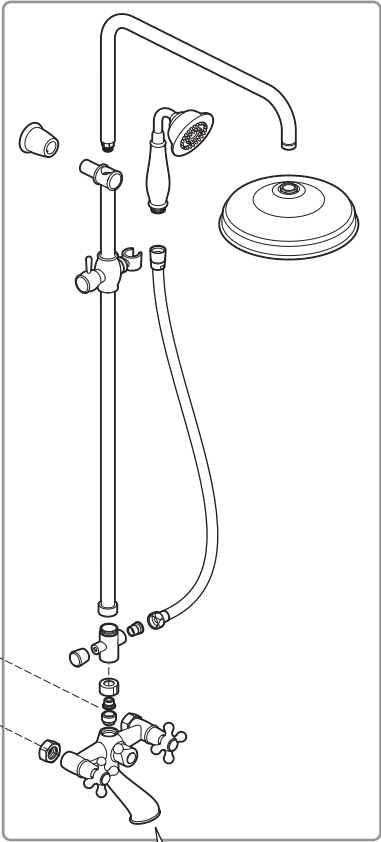

A5A9B4B

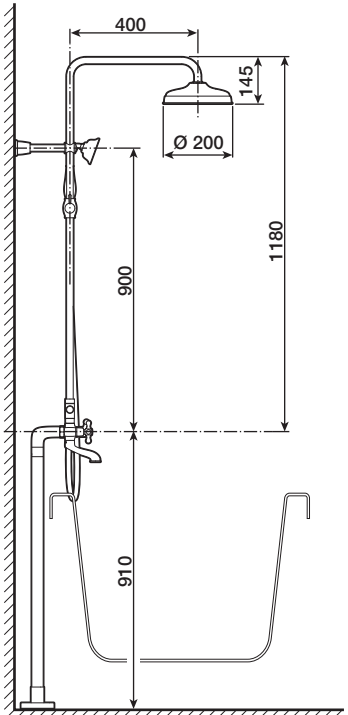

A523095707

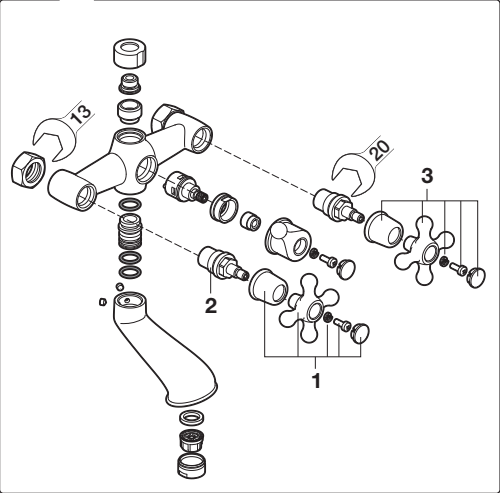
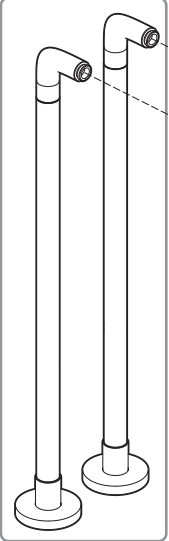

3



A5A274B



A523095707

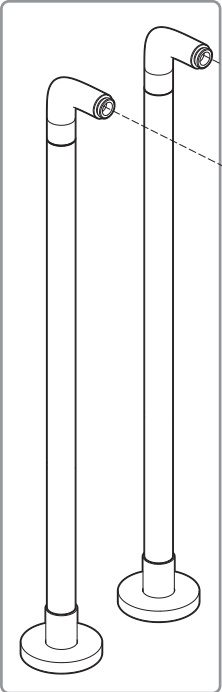
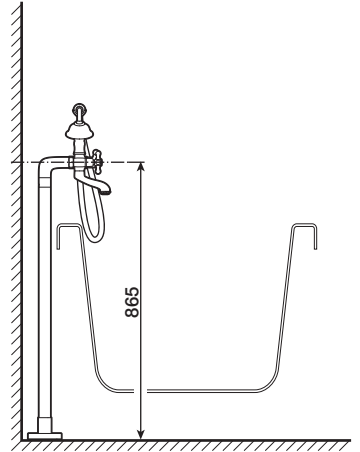
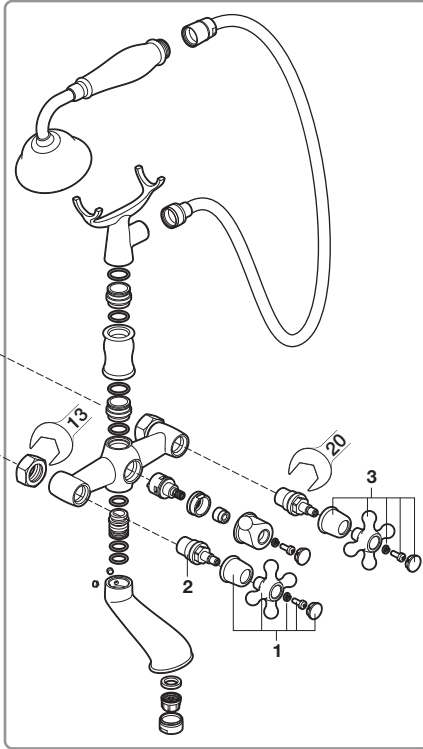

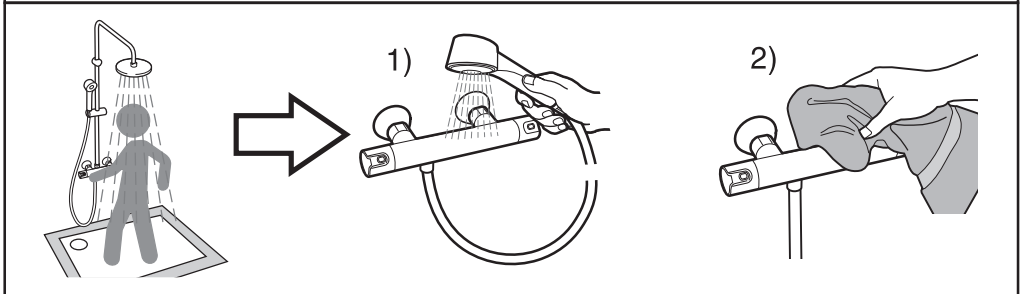
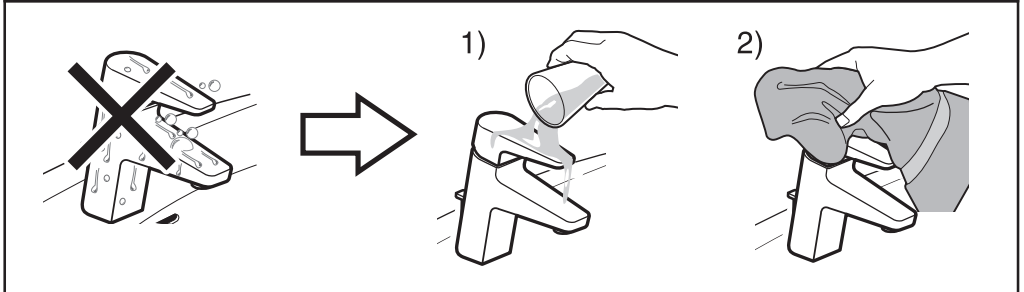
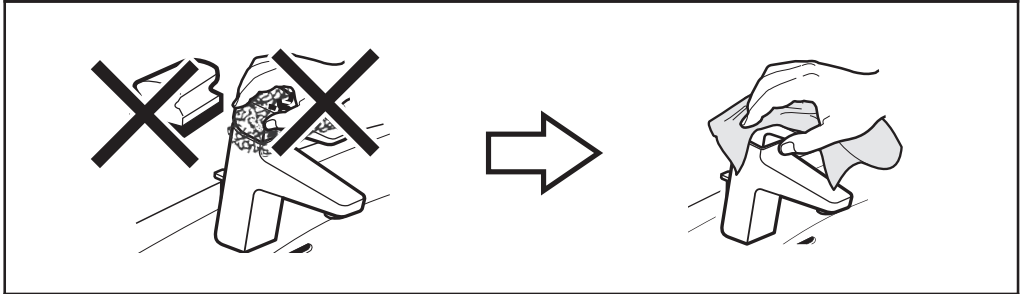
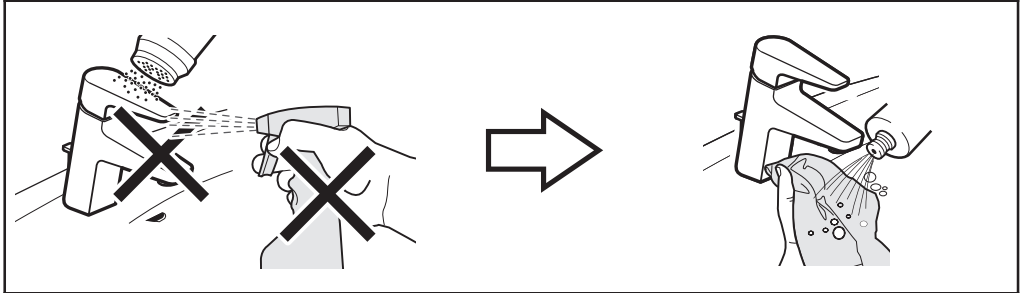
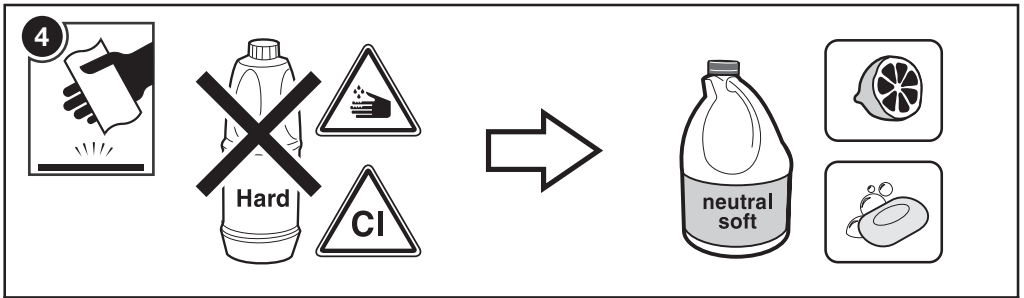



Roca Sanitaryware (Suzhou) Co., Ltd
Address: No.16 Xia Sheng Road 215123,
Suzhou Industry Park, Suzhou, China
Tel: +86 512 6295 3337
Fax: +86 512 6295 3799

Roca Sanitario, S.A.
Avda. Diagonal, 513
08029 Barcelona
SPAIN
www.roca.com

933
661
266

LÍNEA DE ATENCIÓN
AL CONSUMIDOR
ESPAÑA

SERVICIO TÉCNICO
ESPAÑA



productsupport.rs@roca.net
soporteproducto.rs@roca.net

A563093407a